



TO LET



Mount Park Road, Harrow on the Hill, HA1
£3,000 Per month



- CLOAKROOM
- EN SUITE
- CLOSE TO PUBLIC TRANSPORT
- DISH WASHER
- DRIVEWAY
- GAS HOB
- PARKING
- FITTED KITCHEN
- GARAGE
- GARDEN

THE PROPERTY

A spacious 4 bedroom Detached house in the private Mount Park Estate with 4 receptions, modern kitchen/breakfast room & cloaks, en suite & bathroom. Garden, garage & parking. Close to the Village Green with its restaurants & convenience stores. Harrow's shops & Metropolitan Line station are approx 1 mile, Waitrose & Piccadilly Line also close by Available NOW unfurnished Pet Friendly Council Tax Band: G Energy Rating: D67

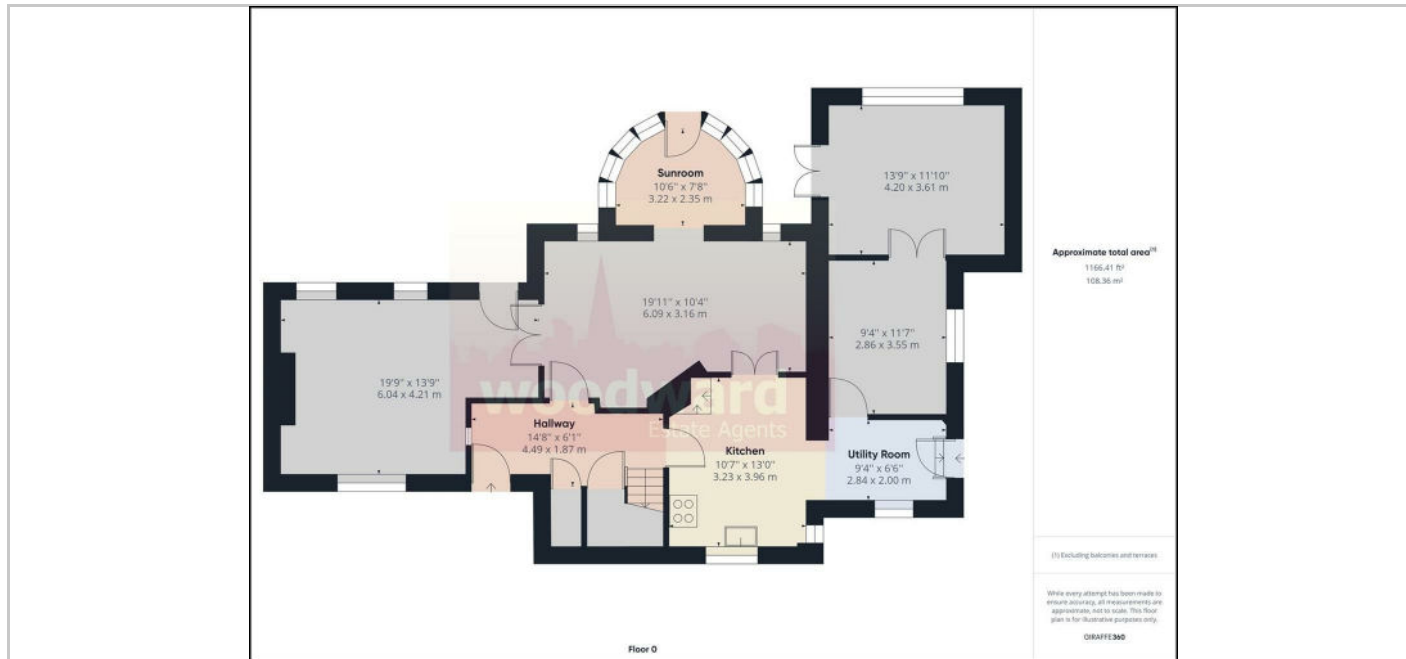

SITUATION

Directions