



Salisbury Road  
Harrow, HA1

Offers in excess of £300,000



## Salisbury Road

Harrow, HA1

Well-Presented Two-Bedroom Flat with Stunning Park Views & Excellent Transport Links

Situated in the heart of Central Harrow, this well-presented first-floor two-bedroom flat offers comfortable and convenient living with beautiful views overlooking Harrow Recreation Ground.

The property features two generous double bedrooms, gas central heating, and double-glazed windows, ensuring warmth and energy efficiency. Residents also benefit from off-street parking and well-maintained communal gardens to the rear.

Located within walking distance of Harrow Town Centre, the flat provides easy access to a variety of bars, coffee shops, restaurants, and shopping facilities. Excellent transport links are nearby, with both Harrow on the Hill Tube Station and Harrow & Wealdstone Station offering National Rail and Underground services for quick connections to Central London and beyond.

Lease will be extended to 179 year on completion





### **Living Room**

14'6" x 10'5" (4.42 x 3.20)

### **Bedroom**

10'6" x 9'11" (3.21 x 3.03)

### **Bedroom**

10'0" x 6'4" (3.06 x 1.94)

### **Kitchen**

9'7" x 6'3" (2.94 x 1.92)

### **Bathroom**

6'5" x 7'0" (1.96 x 2.14)



Floor Plan

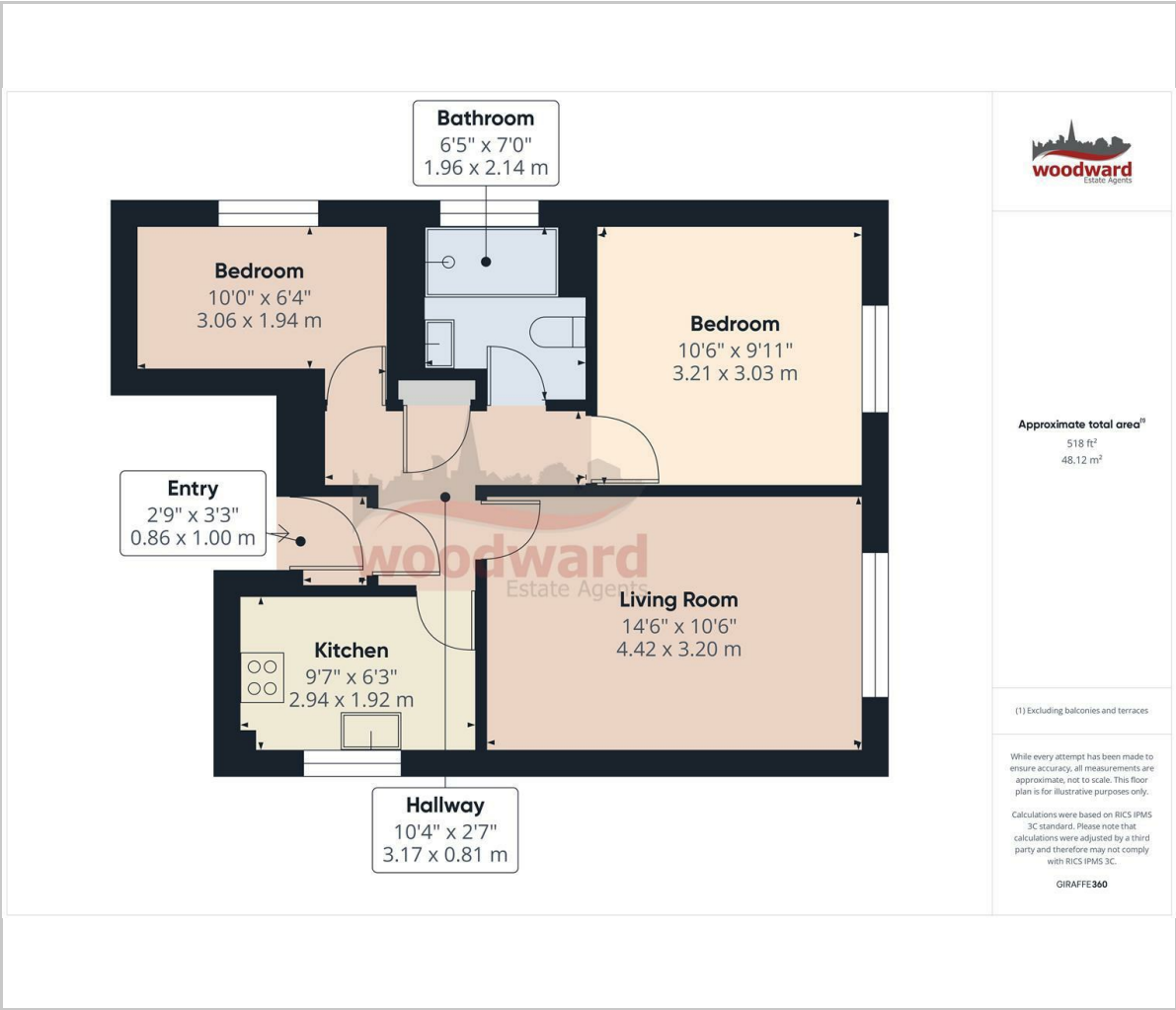

Viewing

Please contact our Woodward Estate Agents Office on 020 8864 8844 if you wish to arrange a viewing appointment for this property or require further information.

These particulars, whilst believed to be accurate are set out as a general outline only for guidance and do not constitute any part of an offer or contract. Intending purchasers should not rely on them as statements of representation of fact, but must satisfy themselves by inspection or otherwise as to their accuracy. No person in this firms employment has the authority to make or give any representation or warranty in respect of the property.

The Old Fire Station 90 High Street, Harrow-on-the-Hill, Middlesex, HA1 3LP  
Tel: 020 8864 8844 Email: [info@woodward.co.uk](mailto:info@woodward.co.uk) <https://www.woodward.co.uk>

Area Map

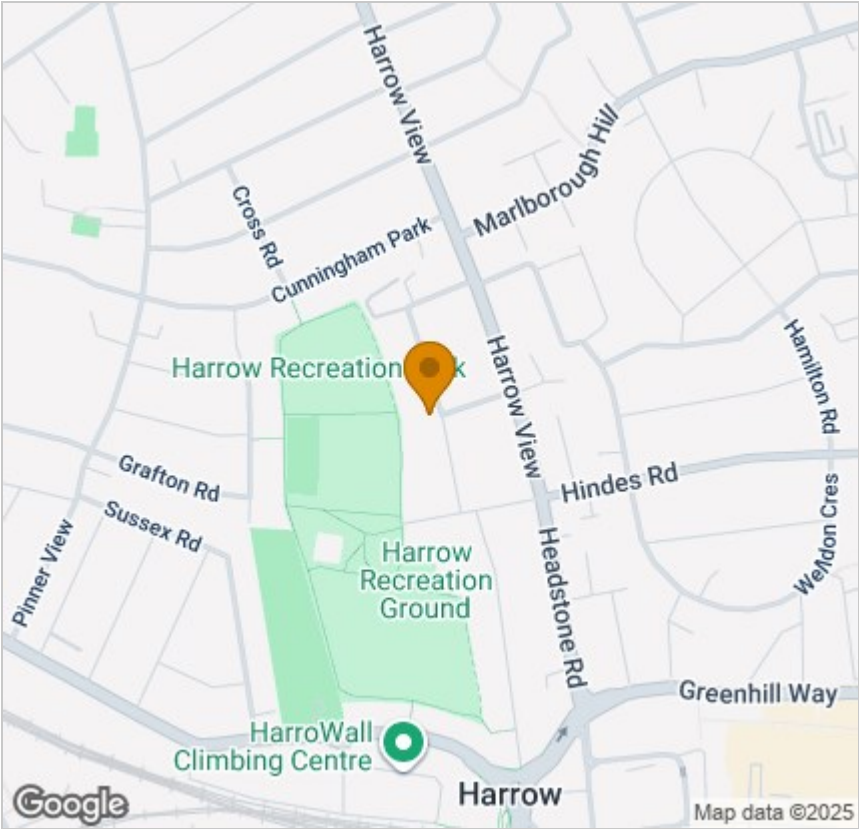

Energy Efficiency Graph

