



Sudbury Hill, Harrow on the Hill, HA1

£1,100 Per month



- Spacious Upper Ground Floor Studio Flat
- Double Wardrobe
- Garage
- Use of Tennis Court
- UnFurnished
- Separate Fitted Kitchen
- Permit Parking
- Communal Garden
- Close to Piccadilly/BR/Metropolitan Line Stations

## THE PROPERTY

Available 21st July. A spacious upper ground floor studio apartment offering well-presented accommodation in a sought-after residential development. The property benefits from a separate fitted kitchen, a double wardrobe, a private garage, permit parking, attractive communal gardens, and the use of residents' tennis courts. Conveniently located within half a mile of local Piccadilly Line stations and approximately one mile from Harrow-on-the-Hill Metropolitan Line Station, the property also enjoys easy access to a range of shopping and leisure facilities. Available Unfurnished Council Tax Band B EPC Rating: C75

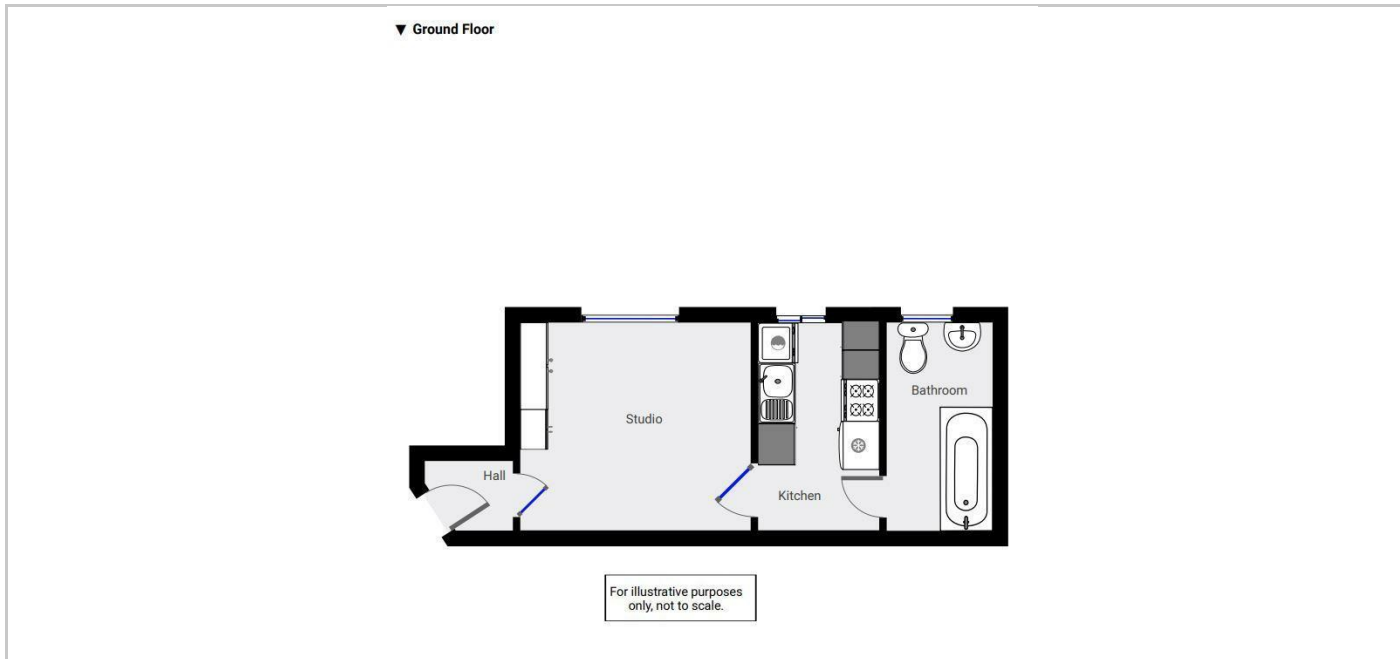

## SITUATION

## Directions