



Sudbury Hill, Harrow on the Hill, HA1

£1,000 Per month



- Spacious Upper Ground Floor Studio Flat
- Double Wardrobe
- Garage
- Use of Tennis Court
- UnFurnished
- Separate Fitted Kitchen
- Permit Parking
- Communal Garden
- Close to Piccadilly/BR/Metropolitan Line Stations

## THE PROPERTY

Available from 14th March. A spacious upper ground floor studio Flat with fitted separate kitchen, double wardrobe, Garage, Permit Parking, Communal Gardens and use of Tennis Courts. Located within half a mile of Piccadilly Line Stations & 1 mile from Harrow on the Hill Metropolitan Line Station and shopping facilities. Available Unfurnished Council Tax Band B EPC Rating: C75

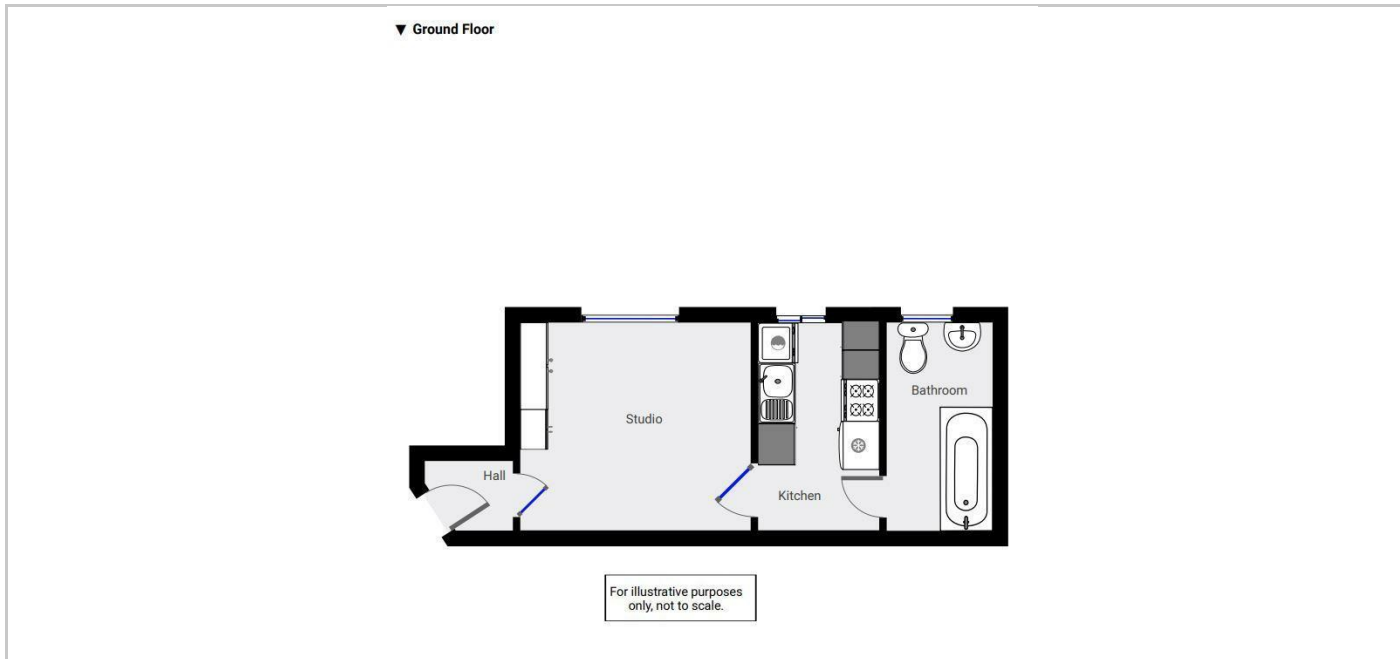

## SITUATION

## Directions