



TO LET

35 Sheepcote Road, Harrow, HA1

£1,350 Per month



- 1 Bedroom Top Floor Flat
- Fitted Kitchen
- Modern Bathroom
- Bedroom with Fitted Wardrobes
- Non Designated Permit Parking
- Close to Metropolitan/BR Stations
- Furnished

THE PROPERTY

A one bedroom top floor flat with loft access and features including Fitted Kitchen including gas hob, lounge/dining room with a view, bedroom with fitted wardrobes, Modern bathroom with shower & Non designated permit parking. Ideally situated just a few minutes walk from both Harrow on the Hill & Northwick Park Metropolitan Line stations and Harrow's excellent shopping facilities. Available furnished from 11th Oct Tax Band: C EPC Rating: C76

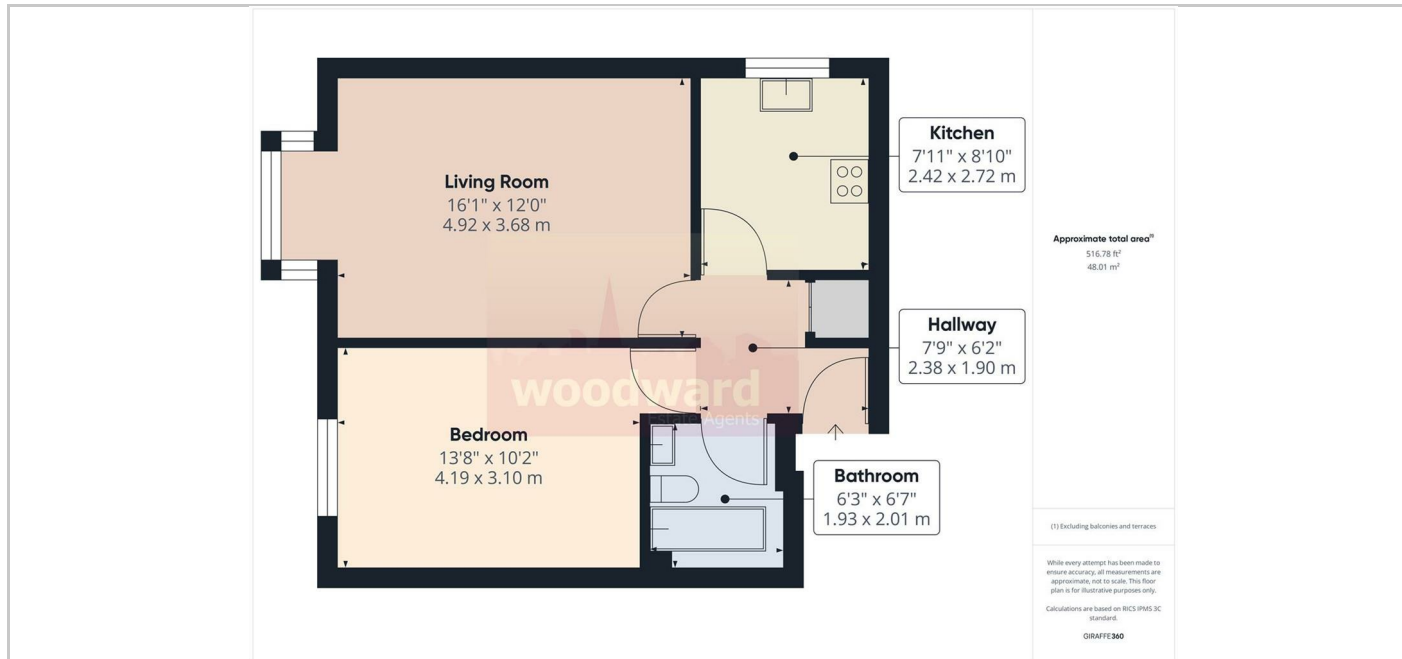

SITUATION

Directions

The Old Fire Station 90 High Street, Harrow-on-the-Hill, Middlesex, HA1 3LP
Tel: 020 8864 8844 Email: info@woodward.co.uk <https://www.woodward.co.uk>