



TO LET

Lower Road, Harrow on the Hill, HA2

£1,600



- 2 Bedroom Cottage
- Lounge/Dining Room
- Small Sunny South Facing Garden
- Close to Piccadilly Line Station
- Modern Fitted Kitchen/Breakfast Room
- Modern Bathroom
- Unfurnished
- Approx. 1 mile Metropolitan Line/BR Station

## THE PROPERTY

Charming 2 bedroom cottage with a modern fitted kitchen/breakfast room, lounge/dining room, then on the half landing is a modern bathroom with large shower/sunken bath and on the first floor are two bedrooms. Outside is a small but sunny South facing garden. Located close to all amenities including Piccadilly Line station & Waitrose. Harrow's excellent shopping & leisure facilities and Metropolitan Line/BR station is approximately 1 mile. Available unfurnished from 19th August. Council Tax Band: C EPC Rating: D56

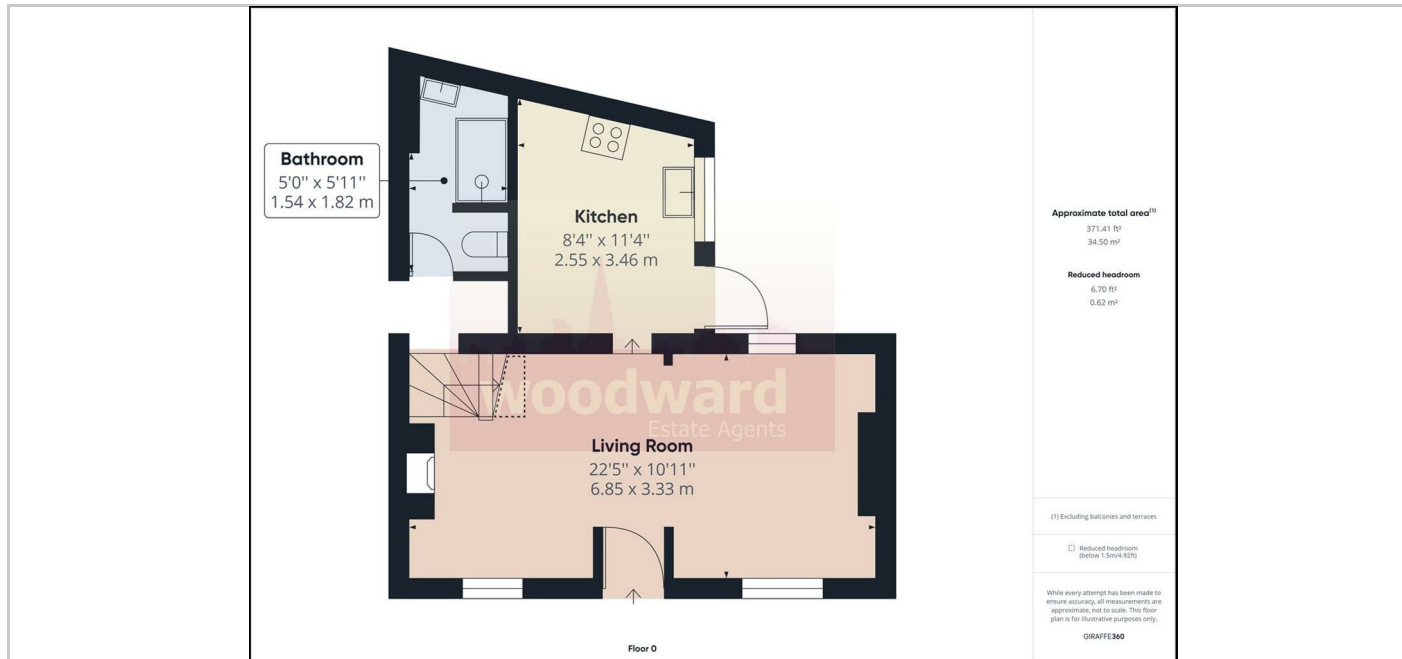

## SITUATION

## Directions