



TO LET

Mount Park Road, Harrow on the Hill, HA1

£3,000 Per month



- CLOAKROOM
- EN SUITE
- CLOSE TO PUBLIC TRANSPORT
- DISH WASHER
- DRIVEWAY
- GAS HOB
- PARKING
- FITTED KITCHEN
- GARAGE
- GARDEN

THE PROPERTY

A spacious 4 bedroom Detached house in the private Mount Park Estate with 4 receptions, modern kitchen/breakfast room & cloaks, en suite & bathroom. Garden, garage & parking. Close to the Village Green with its restaurants & convenience stores. Harrow's shops & Metropolitan Line station are approx 1 mile, Waitrose & Piccadilly Line also close by Available NOW unfurnished Pet Friendly Council Tax Band: G Energy Rating: D67

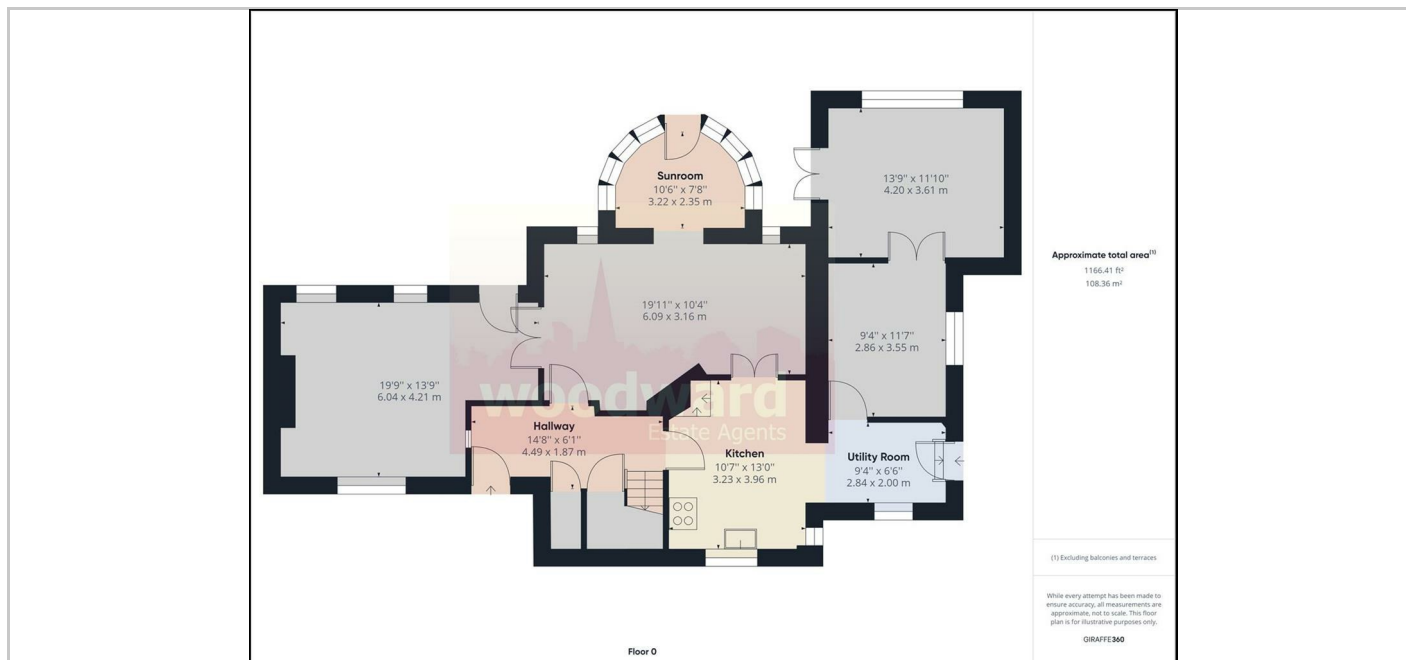

SITUATION

Directions

The Old Fire Station 90 High Street, Harrow-on-the-Hill, Middlesex, HA1 3LP
Tel: 020 8864 8844 Email: info@woodward.co.uk <https://www.woodward.co.uk>